

THE REPRODUCTION, DISTRIBUTION AND UTILIZATION OF THIS DOCUMENT AS WELL AS THE COMMUNICATION OF ITS CONTENTS TO OTHER WITHOUT EXPLICIT AUTHORIZATION IS PROHIBITED. OFFENDERS WILL BE HELD LIABLE FOR THE PAYMENT OF DAMAGES. ALL RIGHT RESERVED IN THE EVENT OF THE GRANT OF A PATENT, UTILITY MODEL OR DESIGN. (PER ISO 15016)

REVISIONS			
REV	DESCRIPTION	DATE	APPROVED
B	REDRAWN - SUPERSEDES 1GA_FJA_ REV. "A" FOR 1GA16FJB16 (1) NOTE #1(c) WAS: "CRIMP NUT PER ACES 2409P2" (2) WAS 84 REF	12-15-95	EN-F16131 DP-24900

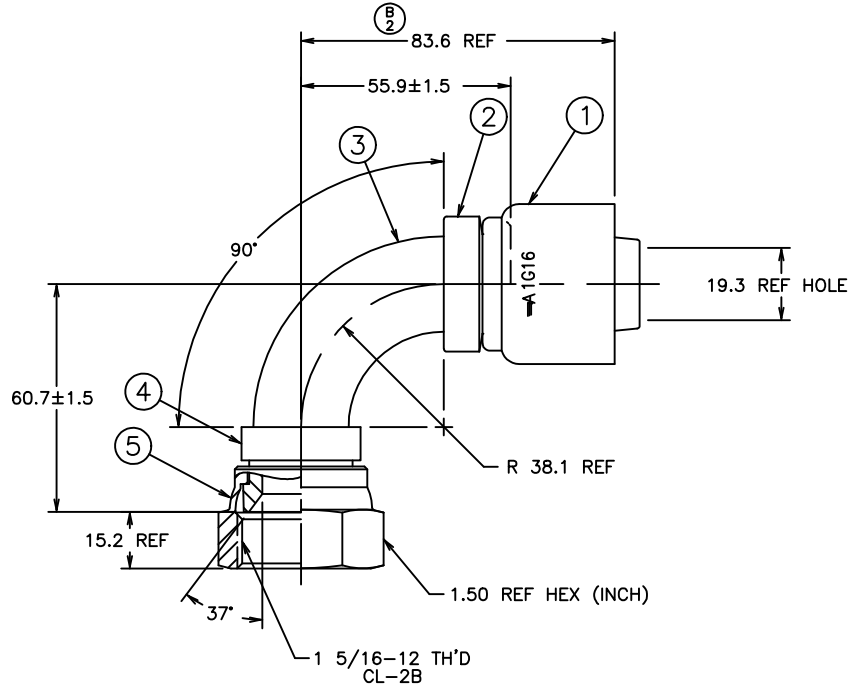

83.6	3.29
60.7±1.5	2.39±.06
55.9±1.5	2.20±.06
38.1	1.50
19.3	.76
15.2	.60
MM	INCH

CONVERSION

METRIC

CONVERTED DRAWING CADAM to AutoCAD 8/98

- △ 3. CAN BE MADE FROM TUBING PER SPECIFICATIONS ON ELBOW DRAWING.
2. 1SA16FJB16 NIPPLE ASSEMBLY MAY BE SUBSTITUTED FOR ITEMS #2, #3, #4 AND #5.
1. PROCESS AS FOLLOWS:
- (a) BRAZE PER ACES 2814.
 - (b) ZINC PLATE PER ACES 2751. (B)
 - (c) CRIMP NUT PER ACES 2813.
 - (d) ASSEMBLE SOCKET PER ACES 2813.

ITEM NO.	MATERIAL	1GA16FJB16	1G16	1F40014-1616AB	FC2962-16S	FC2775-1616S	210204-16S
		AEROQUIP PART NUMBER	(1) SOCKET	(2) NIPPLE	(3) ELBOW	(4) SHOULDER	(5) NUT
LIST OF MATERIALS							
		DRAWN J.L. HUFFMAN		FLUID CONVEYANCE DIVISION			
		CHECKED R.GARRETT		DRAWING TITLE			
		APPROVED R.GARRETT		FITTING ASSEMBLY			
		RELEASE DATE 12-15-95		90°, SAE 37° SWIVEL, OTC			
		EN-F16131 DP-24900		SIZE C	DRAWING NUMBER 1GA16FJB16	REV B	
		THIRD ANGLE PROJECTION		SCALE 1/1	DIST U	CAGE CODE 01276	SHEET NO

DWG. NO. 1GA16FJB16 SH. REV. B