

THE REPRODUCTION, DISTRIBUTION AND UTILIZATION OF THIS DOCUMENT AS WELL AS THE COMMUNICATION OF ITS CONTENTS TO OTHERS WITHOUT EXPLICIT AUTHORIZATION IS PROHIBITED. OFFENDERS WILL BE HELD LIABLE FOR THE PAYMENT OF DAMAGES. ALL RIGHT RESERVED IN THE EVENT OF THE GRANT OF A PATENT, UTILITY MODEL OR DESIGN. (PER ISO 18018)

REVISIONS

REV	DESCRIPTION	DATE	APPROVED
D	REDRAWN - SUPERSEDES 1GA_FRB_SHEET 2 REV.'C' FOR 1GA12FRB12	12-8-95	EN-F16102 DP-24900

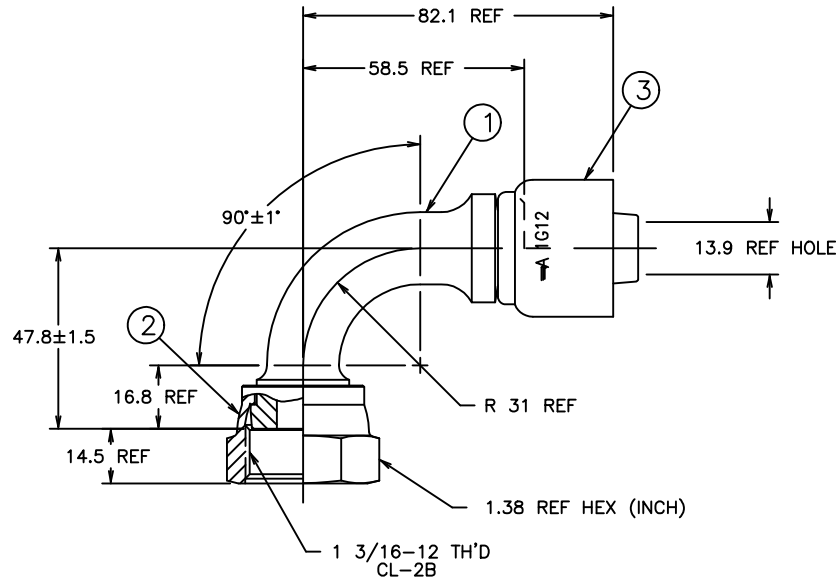

82.1	3.23
58.5	2.30
47.8±1.5	1.88±.06
31	1.22
16.8	.66
14.5	.57
13.9	.55
MM	INCH

CONVERSION

METRIC

2. 1SA12FRB12 NIPPLE ASSEMBLY MAY BE SUBSTITUTED FOR ITEMS #1 AND #2.

1. PROCESS AS FOLLOWS:
- BEND NIPPLE TO DIMENSIONS SHOWN.
 - ZINC PLATE PER ACES 2751.
 - CRIMP NUT PER ACES 2409P1.
 - ASSEMBLE SOCKET PER ACES 2813.

ITEM NO.	MATERIAL	1GA12FRB12	1F40023-1212AB	FC1473-12S	1G12
		AEROQUIP PART NUMBER	① NIPPLE	② NUT	③ SOCKET
LIST OF MATERIALS					
		DRAWN M MOLINA		FLUID CONVEYANCE DIVISION DRAWING TITLE FITTING ASSEMBLY 90°, ORS FEMALE SWIVEL, OTC	
		CHECKED R.D.GARRETT			
		APPROVED R.D.GARRETT			
		RELEASE DATE 12-8-95			
		EN-F16102 DP-24900		SIZE C	DRAWING NUMBER 1GA12FRB12
		THIRD ANGLE PROJECTION		SCALE 1/1	DIST U
				CAGE CODE 01276	SHEET NO

DWG. NO. 1GA12FRB12 SH. D

CONVERTED DRAWING CADAM to AutoCAD 8/98