

REV	DESCRIPTION	BY	CHK	DATE	ECN
A	ENGINEERING RELEASE	AGJ		5-9-05	M64632
B	ADDED DIMENSION 24.46-24.21/[.963-.953]	PM		6-13-05	M64843
C	53.1/51.1[2.09/2.01] WAS 53.1/51.3[2.09/2.02]	PM		8-18-05	52660
D	-1> MAX COUPLING LENGTH WAS 42.4 [1.67] -2> "...TOOTH 16/32 SPLINE..." WAS "...TOOTH 12/24 SPLINE..."	CSG	SKS	1-27-11	M81168
E	-1>NOTE 1 WAS "MOUNTING TYPE: OPTION AT" -2>UPDATED DRAWING TO CURRENT STANDARD	AAB	CSG	10-24-11	M83622
F	ADDED MOUNTING OPTION "AC"	MPN	VVH	10-14-19	M111606

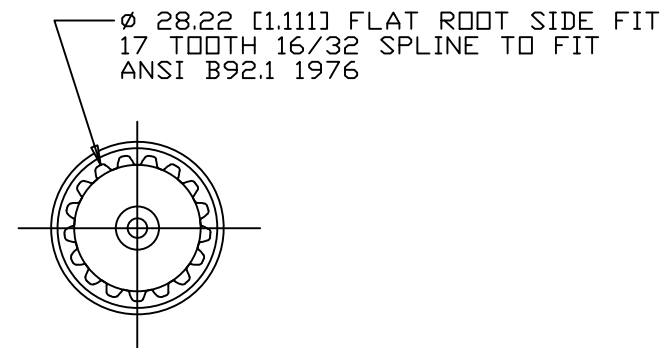
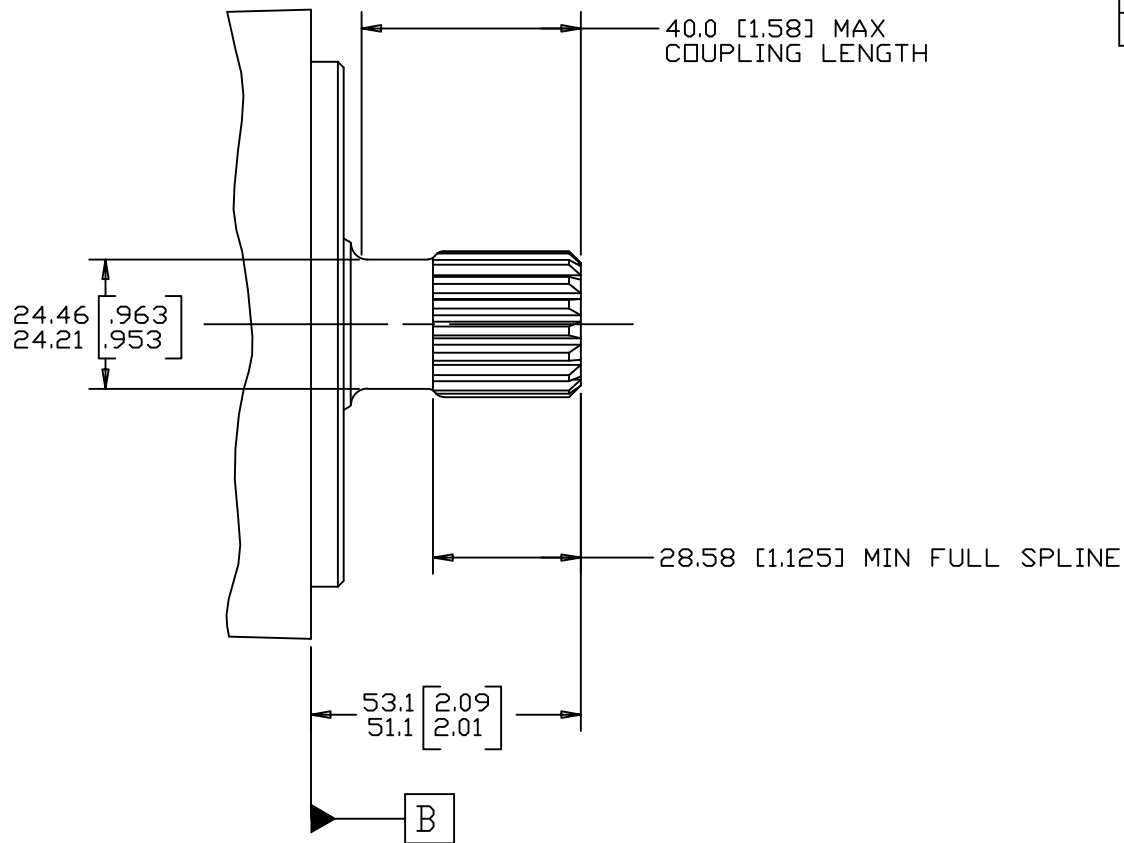

C S REVIEWED FOR CLASSIFICATION PER ESP-042

NOTE

- 1 MOUNTING TYPE: OPTION AC, AT, BM
- 2 OUTPUT SHAFT: OPTION 17

UNLESS OTHERWISE SPECIFIED ALL DIMENSIONS ARE IN		DRAWING BASED ON ASME Y14.5M-1994	
INCHES <input type="checkbox"/>	MILLIMETERS <input checked="" type="checkbox"/>	THE REPRODUCTION, DISTRIBUTION, AND UTILIZATION OF THIS DOCUMENT, AS WELL AS THE COMMUNICATION OF ITS CONTENTS TO OTHERS WITHOUT EXPLICIT AUTHORIZATION IS PROHIBITED. OFFENDERS WILL BE HELD LIABLE FOR THE PAYMENT OF DAMAGES. ALL RIGHTS RESERVED IN THE EVENT OF THE GRANT OF A PATENT, UTILITY MODEL, OR DESIGN. (PER ISO 16016)	
TOLERANCES			
.x ± ----	.xx ± REF		
.xxx ± ONLY	< ± ----	DRAWN BY/DATE AGJ 5-11-04	MATERIAL/HEAT TREAT
UNSPECIFIED RADII ARE ----	ENGRG BY/DATE JML 5-11-04	CHECKED BY/DATE SMM 5-11-04	TITLE 4000 COMPACT SERIES MOTOR SHAFT INSTALLATION
UNSPECIFIED DRAFT ANGLES ARE ----	METALLURGY BY/DATE ----	MICROINCHES <input type="checkbox"/> NUMBER A-1330-052	
B SIZE	THIRD ANGLE PROJECTION	DO NOT SCALE	SCALE 1/1 SHEET 1 OF 1
		ARITHMETICAL AVERAGE <input checked="" type="checkbox"/>	