

DISPL CODE	G	MAX
022	132.2	[5.21]
025	133.1	[5.24]
030	134.6	[5.30]
036	136.4	[5.37]
040	137.6	[5.42]
049	140.3	[5.53]
062	144.2	[5.68]
080	149.6	[5.89]
096	154.5	[6.08]
119	161.2	[6.35]
149	170.3	[6.70]
187	181.7	[7.15]
226	193.3	[7.61]
298	215.0	[8.46]

REV	DESCRIPTION	BY	CHK	DATE	ECN / MPS
A	ENGINEERING RELEASE	SMM		11-17-03	M60360
D	REVISED	SSD		5-10-10	M79078
E	(4A) NOTE 3 WAS CASE DRAIN: 0...	SSPYUP		12-26-15	0068068_2

D

D

C

C

B

B

A

A

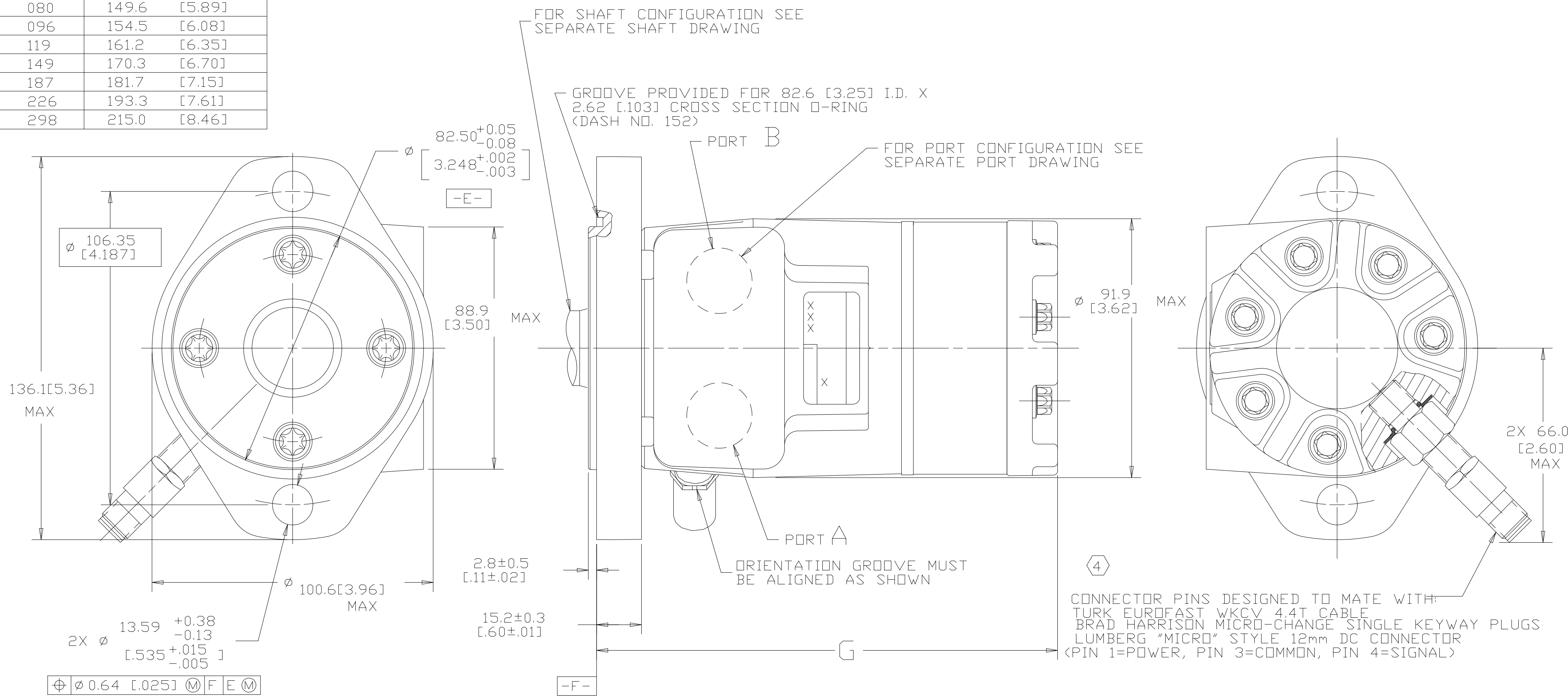

NOTE

1 ROTATION STANDARD WHEN FACING SHAFT END OF MOTOR SHAFT TO ROTATE CLOCKWISE WHEN PORT "A" IS PRESSURIZED COUNTERCLOCKWISE WHEN PORT "B" IS PRESSURIZED

REVERSE WHEN FACING SHAFT END OF MOTOR SHAFT TO ROTATE CLOCKWISE WHEN PORT "B" IS PRESSURIZED COUNTERCLOCKWISE WHEN PORT "A" IS PRESSURIZED

2 MOUNTING FLANGE AA = STANDARD, 2 BOLT: ∅ 82.6 [3.25] X 3.0 [.12] PILOT ∅ 13.59 [1.535] HOLES ON ∅ 106.2 [4.18] BOLT CIRCLE

3 CASE DRAIN 00 = NO CASE DRAIN

4 SENSOR OUTPUT WILL BE 60 ELECTRICAL PULSES PER SHAFT REVOLUTION. SUPPLY VOLTAGE: 8 TO 28 Vdc OUTPUT VOLTAGE: LOW .5 Vdc AT 10 mA; HIGH Vs-1 Vdc

REVIEWED FOR CLASSIFICATION PER ESP-042

UNLESS OTHERWISE SPECIFIED ALL DIMENSIONS ARE IN INCHES MILLIMETERS [INCHES]	DRAWING BASED ON ANSI Y14.5M-1982	
	THE REPRODUCTION, DISTRIBUTION AND UTILIZATION OF THIS DOCUMENT AS WELL AS THE COMMUNICATION OF ITS CONTENTS TO OTHER WITHOUT EXPLICIT AUTHORIZATION IS PROHIBITED. OFFENDERS WILL BE HELD LIABLE FOR THE PAYMENT OF DAMAGES. ALL RIGHT RESERVED IN THE EVENT OF THE GRANT OF A PATENT, UTILITY MODEL OR DESIGN. (PER ISO 16016)	
	TOLERANCES .X ± --- .XX ± --- .XXX ± --- ∠ ± ---°	MATERIAL/HEAT TREAT ---
	UNSPECIFIED RADII ARE: ---	TITLE T-MOTOR INSTALLATION
UNSPECIFIED DRAFT ANGLES ARE: ---°	THIRD ANGLE PROJECTION DO NOT SCALE	NUMBER A-821-090
C SIZE	DO NOT SCALE	SCALE 1/1 SHEET 1 OF 1

