

REV	DESCRIPTION	BY	CHK	DATE	ECN
A	ENGINEERING RELEASE	SMM		09-11-01	M26280
B	-1) MOUNTING TYPE OPTION WAS "L" -2) OUTPUT SHAFT OPTION WAS "28"	JSB		12-11-06	0001664
C	-1) REVISED PICTORIALY -2) WAS 189.7-193.5 [7.47-7.62]	SMT	NHB	08-05-09	18782

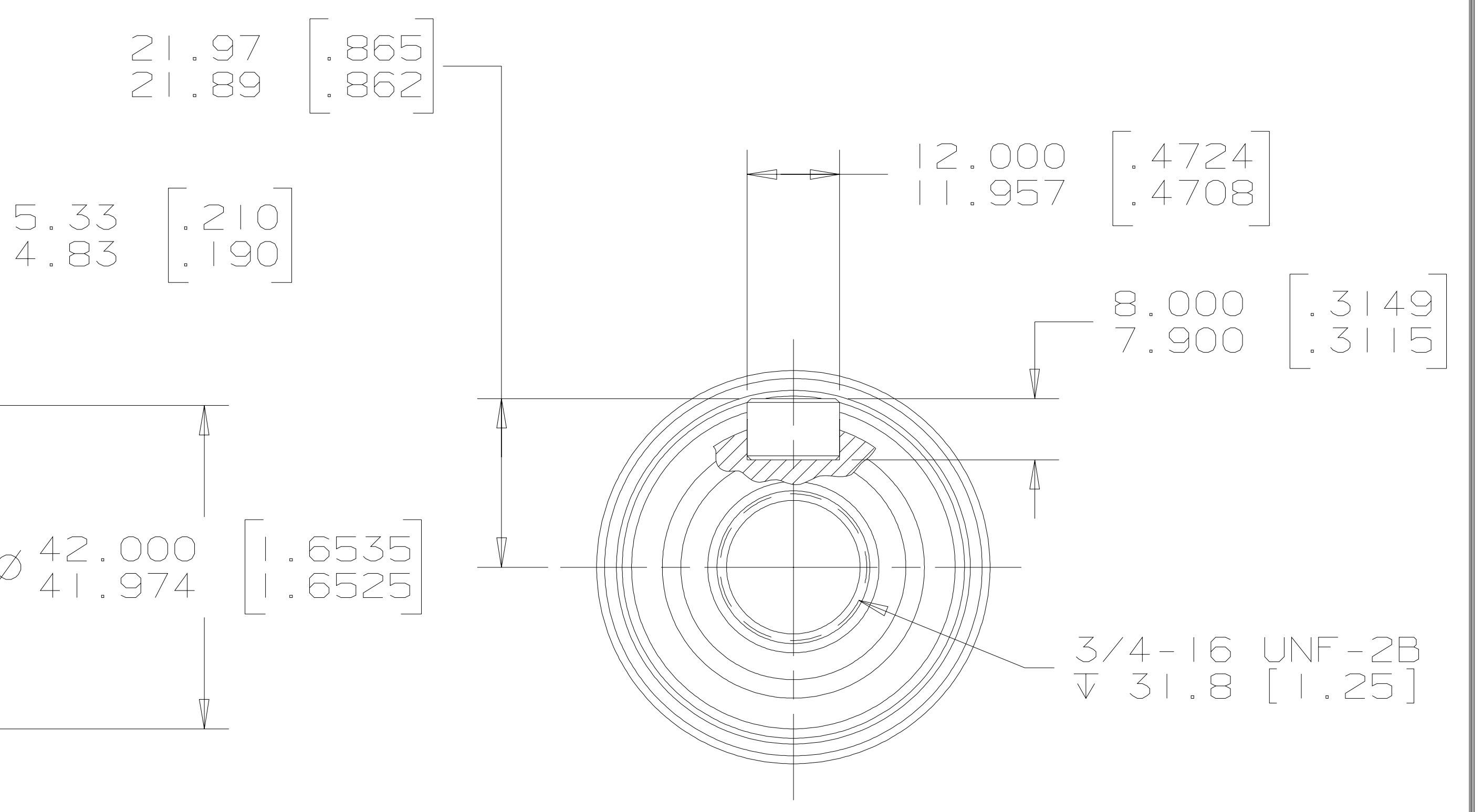

NOTE

1 MOUNTING TYPE: OPTION AL

2 OUTPUT SHAFT: OPTION I7

UNLESS OTHERWISE SPECIFIED ALL DIMENSIONS ARE IN INCHES <input type="checkbox"/> MILLIMETERS [INCHES] <input checked="" type="checkbox"/>	DRAWING BASED ON ANSI Y14.5M-1982	
	THE REPRODUCTION, DISTRIBUTION, AND UTILIZATION OF THIS DOCUMENT, AS WELL AS THE COMMUNICATION OF ITS CONTENTS TO OTHERS WITHOUT EXPLICIT AUTHORIZATION IS PROHIBITED. OFFENDERS WILL BE HELD LIABLE FOR THE PAYMENT OF DAMAGES. ALL RIGHTS RESERVED IN THE EVENT OF THE GRANT OF A PATENT, UTILITY MODEL, OR DESIGN. (PER ISO 16016)	
TOLERANCES .x ±----- .xx ±REF .xxx ±ONLY < ±-----	DRAWN BY/DATE SMM 09-25-01 CHECKED BY/DATE AGJ 10-05-01 ENGRG BY/DATE TRF 10-05-01 METALLURGY BY/DATE -----	MATERIAL/HEAT TREAT TITLE 6K SHAFT INSTALLATION
UNSPECIFIED RADII ARE ---	THIRD ANGLE PROJECTION DO NOT SCALE	MICROINCHES <input checked="" type="checkbox"/> MICROMETERS [MICROINCHES] <input type="checkbox"/> 250/ ARITHMETICAL AVERAGE
UNSPECIFIED DRAFT ANGLES ARE ---	NUMBER A-1037-028	SCALE 1/1 SHEET 1 OF 1
DRAWING FORMAT CADD <input checked="" type="checkbox"/> MANUAL <input type="checkbox"/>		

