

DISPLACEMENT CODE	G MAX
022	132.7 [5.22]
025	133.5 [5.26]
028	132.7 [5.22]
035	136.5 [5.37]
045	136.5 [5.37]
059	139.5 [5.49]
073	142.8 [5.62]
089	146.4 [5.76]
097	148.2 [5.84]
113	151.7 [5.97]
141	158.1 [6.22]
179	166.7 [6.56]
226	177.1 [6.97]
451	228.0 [8.98]

SYM	REVISION	BY	DATE	ECN
A	ENGINEERING RELEASE	RLL	11-10-87	14736
G	REVISED	RPD	03-18-10	78646
H	-1>REVISED PICTORIALY -2>(4D)UPDATED TABULATION FOR G MAX -3>REVISED NOTE AS PER ESP-022-69	AAB	02-17-14	0054755
J	(1C)ADDED EATON LOGO TO END CAP	AAB	01-22-15	0061684
K	NOTE 3 WAS CASE DRAIN: 0 = NO CASE...	ABH	07-27-15	0065202

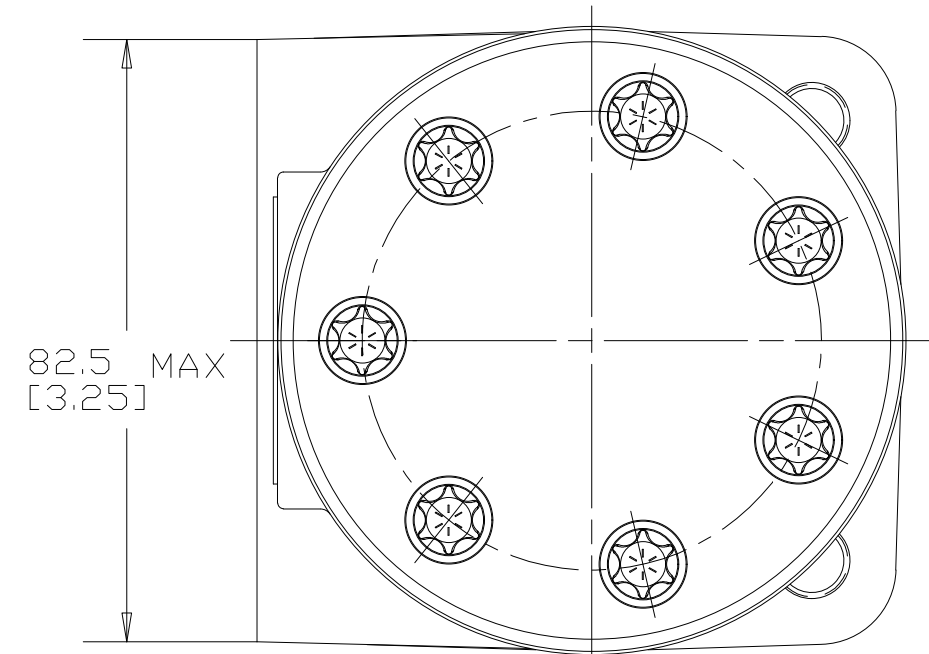
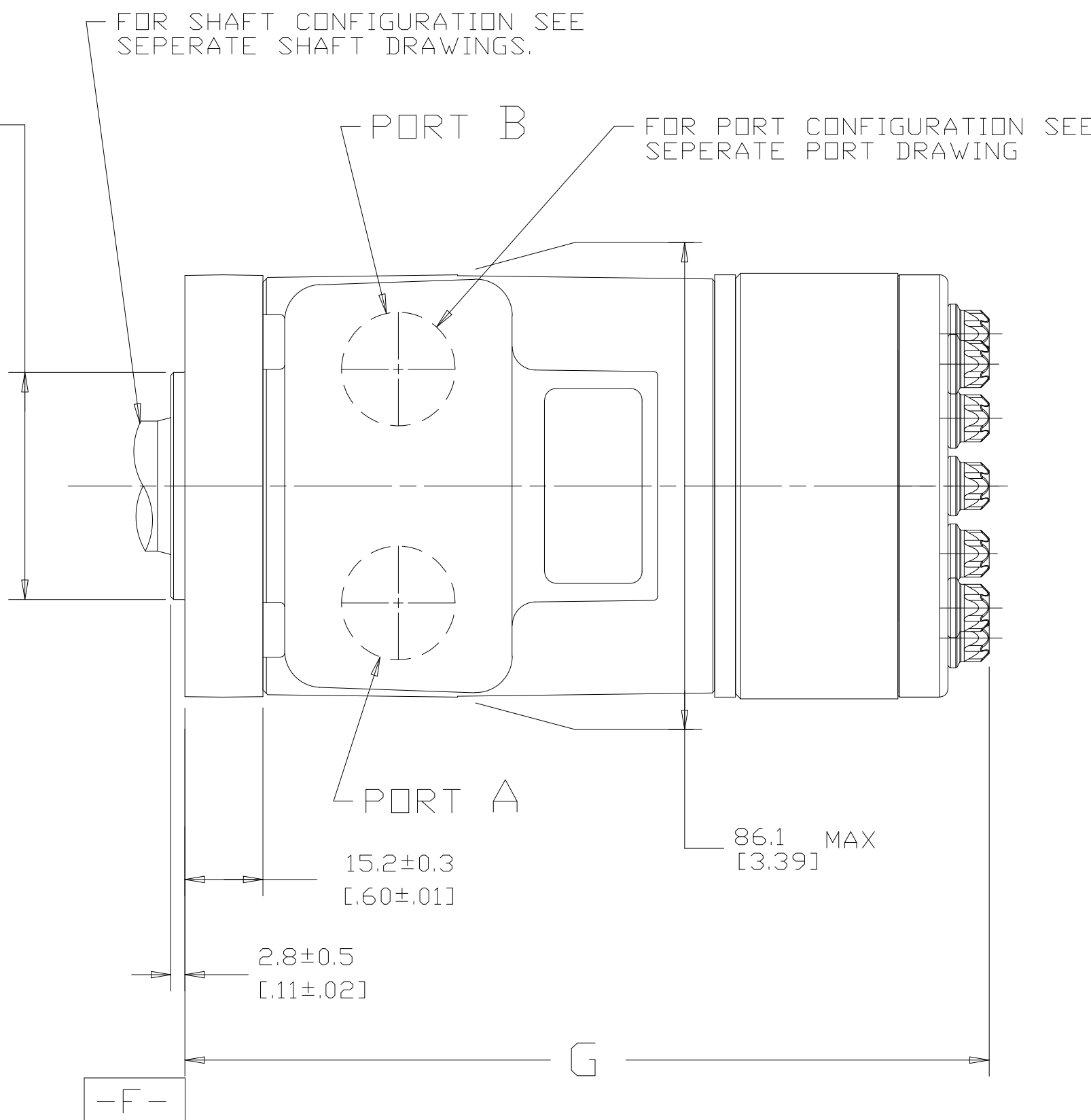
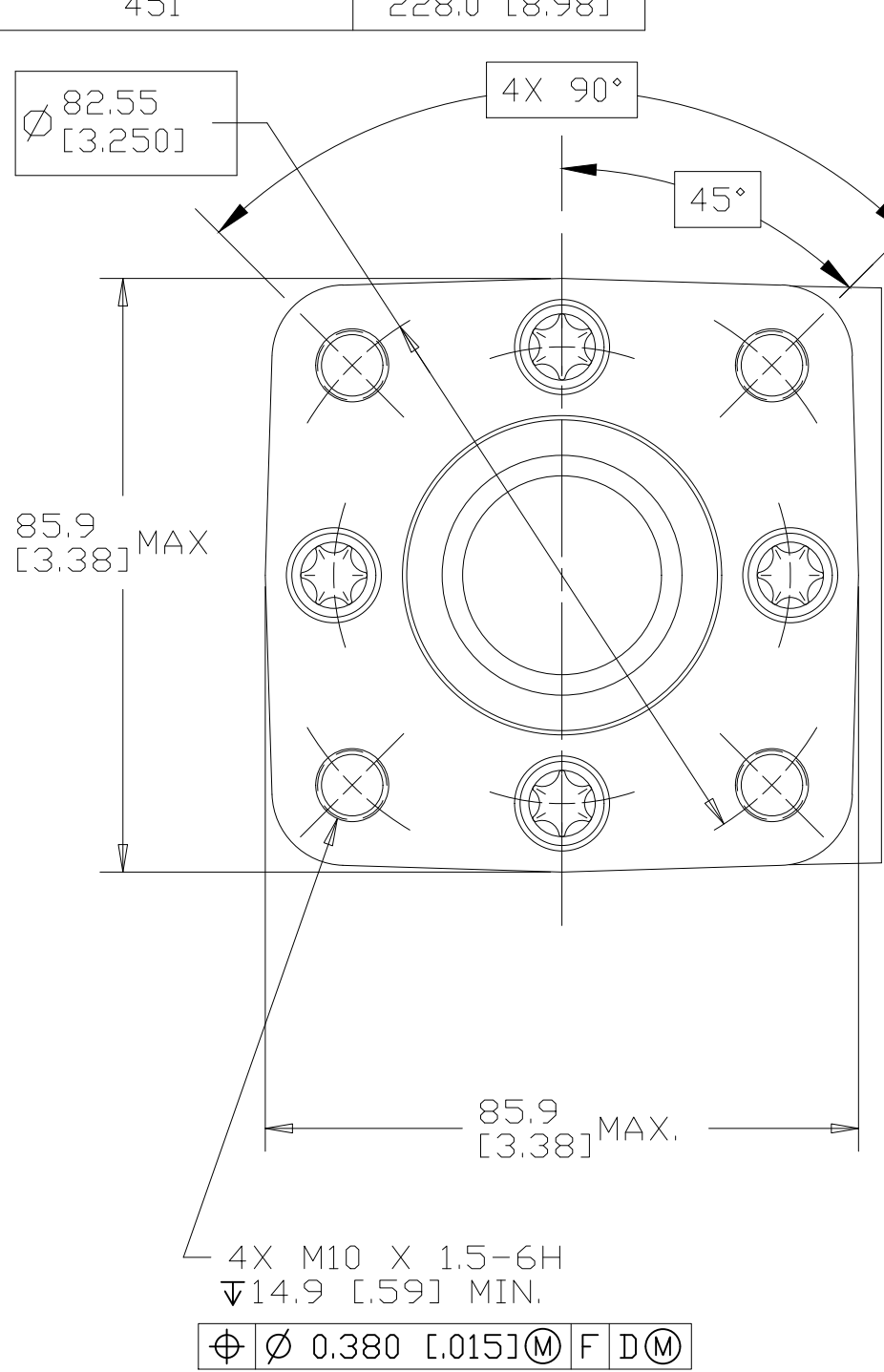

- NOTE:
- ROTATION: STANDARD; WHEN FACING SHAFT END OF MOTOR, SHAFT TO ROTATE CLOCKWISE WHEN PORT "A" IS PRESSURIZED, COUNTERCLOCKWISE WHEN PORT "B" IS PRESSURIZED. REVERSE ; WHEN FACING SHAFT END OF MOTOR, SHAFT TO ROTATE CLOCKWISE WHEN PORT "B" IS PRESSURIZED, COUNTERCLOCKWISE WHEN PORT "A" IS PRESSURIZED.
  - MOUNTING FLANGE: FA = 4 BOLT STD: 44.40 [1.748] DIA. X 3.05 [1.20] PILOT, M10 X 1.5 MOUNTING HOLES ON 82.55 [3.250] DIA. B.C.
  - CASE DRAIN: 00 = NO CASE DRAIN

REVIEWED FOR CLASSIFICATION PER ESP-042

UNLESS OTHERWISE SPECIFIED ALL DIMENSIONS ARE IN INCHES MILLIMETERS [INCHES]	DRAWING BASED ON ANSI Y14.5M-1982	
	THE REPRODUCTION, DISTRIBUTION AND UTILIZATION OF THIS DOCUMENT AS WELL AS THE COMMUNICATION OF ITS CONTENTS TO OTHER WITHOUT EXPLICIT AUTHORIZATION IS PROHIBITED. OFFENDERS WILL BE HELD LIABLE FOR THE PAYMENT OF DAMAGES. ALL RIGHT RESERVED IN THE EVENT OF THE GRANT OF A PATENT, UTILITY MODEL OR DESIGN. (PER ISO 16016)	
TOLERANCES	DRAWN RLL BY/DATE 10-27-87	MATERIAL/HEAT TREAT
.X ± 0.1	CHECKED KQ BY/DATE 1-21-88	
.XX ± 0.01	ENGRG WCW BY/DATE 1-25-88	TITLE
.XXX ± 0.001	METALLURGY	H-MOTOR INSTALLATION
∠ ± 0.5°	BY/DATE	NUMBER
UNSPECIFIED RADII ARE:		A-37-324
-----		SCALE 1/1
UNSPECIFIED DRAFT ANGLES ARE:	THIRD ANGLE PROJECTION	SHEET 1 OF 1
-----°	DO NOT SCALE	
C SIZE	ARITHMETICAL AVERAGE	

